

# Vasofix<sup>®</sup> Safety

## IV Catheter



1a



1b



1c

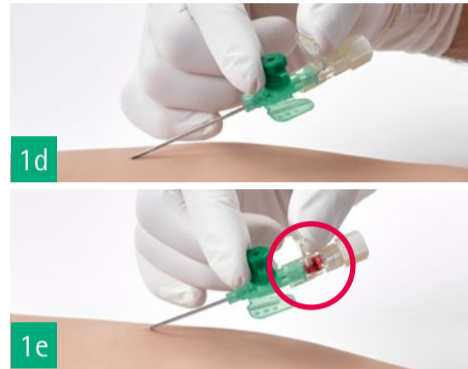

1d



1e

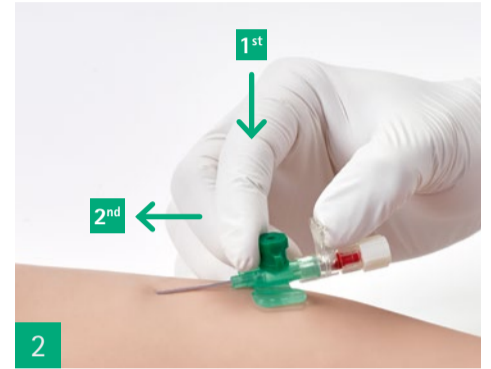

2

### Preparation

- Confirm all items are accessible for insertion and stabilization
- Select and prepare site as per organizational policies
- Open packaging and remove IV catheter from blister (1a)
- Flex stabilization wings before returning them to horizontal position (1b)
- Remove protective cap in a straight outward motion (1c)

### Insertion

- Confirm catheter hub is properly seated on flashback chamber
- Hold the catheter on the port and the grip plate (1d)
- Anchor the vessel with gentle skin traction
- Adjust angle of insertion and access vessel
- First flashback of blood is observed in the flashback chamber and confirms vessel entry (1e)

### Lower and advance slightly

- Lower and advance the entire catheter and needle unit slightly to ensure catheter tip is in vessel



3



4



5



6



7

### Advance catheter

- Advance catheter off the needle slightly
- Observe second blood flashback between the needle and catheter to confirm catheter is in the vessel
- After confirmation, continue advancing catheter off the needle and into vessel

### Occlude and stabilize catheter

- Occlude vein distal to catheter tip to interrupt flow of blood
- Stabilize catheter hub to prevent catheter dislodgement
- Withdraw needle in a controlled and continuous motion
- Discard needle immediately into sharps-proof container

### Catheter hub closure (5)

- Immediately connect infusion line or accessory device and flush according to organizational policies

### Catheter stabilization (6)

- Stabilize catheter and apply sterile dressing according to organizational policies

### Integrated injection port

- For bolus injections open the injection port and attach syringe to injection port with a slight twisting movement
- The injection port contains a valve which opens and closes automatically
- After injection immediately close protective cap
- Turn protective cap 180 degrees to "lock it"

### Components

- 1 | Flashback Chamber
- 2 | Protective Guard
- 3 | Catheter Hub
- 4 | Safety Shield
- 5 | Closing Cone
- 6 | Grip Plate
- 7 | Injection Port
- 8 | Fixation Wings

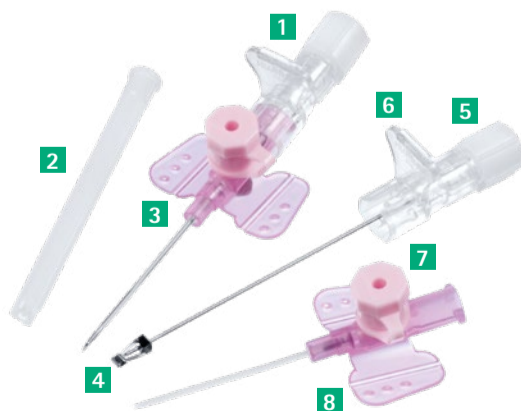

### Caution

Never reinsert the needle into catheter; catheter shearing may occur, causing an embolism. Care should be taken not to leave the catheter hub open without connecting to an accessory device. In the case of an unsuccessful venipuncture, remove the needle first to activate safety mechanism, then remove catheter from patient. Refer to packaging insert for complete instruction for use.